

South Beach Road, Hunstanton, Norfolk PE36 5BB

Holiday Home Sales 01485 536026 Fax 01485 536015

Email: lodges@searles.co.uk www.searles.co.uk

New Pathfinder Retreat 2023

48' x 20' 3 Bed

Location RG131

£259,995

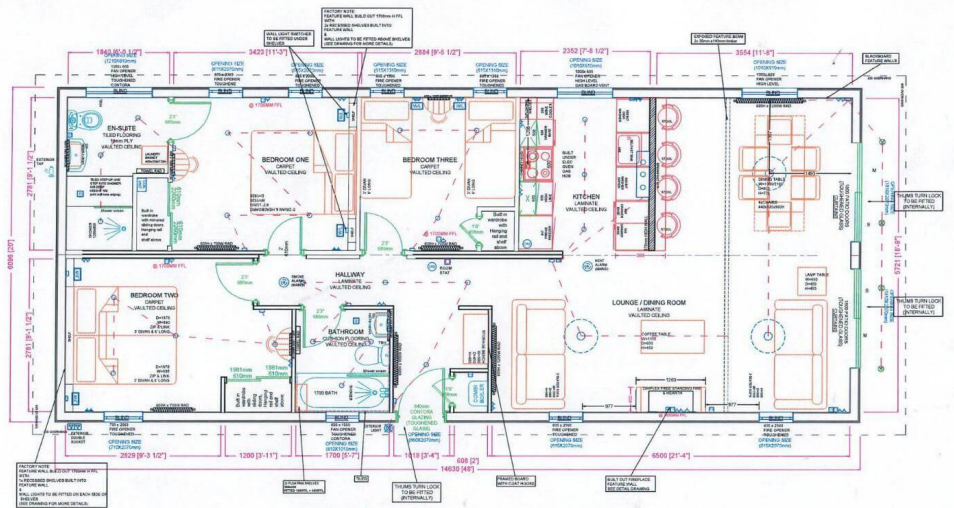

This beautiful lodge has 3 bedrooms and is located in Redgate Court where there is spacious parking for 3 vehicles.

Upon entry you walk into an cloak area to hang your the outdoor belongings before entering into the spacious open plan kitchen/diner/living room.

The rustic farmhouse aesthetic throughout forms a unique homely experience, with plenty light pouring in, that creates a warming atmosphere. The kitchen includes an island where four stalls are located opening onto the dining area. With a oven, hob and extractor fan, and also a dishwasher. The lounge has 2 double sofas. The living area has 2 sliding doors that stretch out onto the large decking which welcomes sun throughout the day. The holiday home has two spacious double bed bedrooms with the master flowing onto an en suite which encompasses a large shower, toilet and basin. Both double bedroom have integrated mirrored wardrobes with ample storage space and a dressing table and stall. The 3rd bedroom is a large twin with a side table and wardrobe space. Includes an upgrade to a larger than normal grey UPVC decking with glass balustrades.

